

Electrolux

SPARE PARTS CATALOGUE
CATALOGO PARTI DI RICAMBIO

GREENE KING ELECTRIC GRIDDLE
GREENE KING FRYTOP ELETTRICO

PNC	Model	Ref	Version	Notes
169167	ARE24FLCE	A	EL	ELECTRIC GRIDDLE-SMOOTH PLATE 24"
169168	ARE36FLCE	B	EL	ELECTRIC GRIDDLE-SMOOTH PLATE 36"
169169	ARE24FRCE	C	EL	ELECTRIC GRIDDLE-1/2 SMOOTH/1/2 RIBBED 24"
169170	ARE36FRCE	D	EL	ELECTRIC GRIDDLE-1/2 SMOOTH/1/2 RIBBED 36"
169171	ARE48FLCE	E	EL	FRY TOP EL LISCIO GREENE KING
169172	ARE48FRCE	F	EL	ELEC GRIDDLE-1/2 SMOOTH PL. 1/2 RIB 48"

PAG	INDEX	INDICE
2	General Components	Componenti struttura
3/4	Spare Parts List	Lista Ricambi

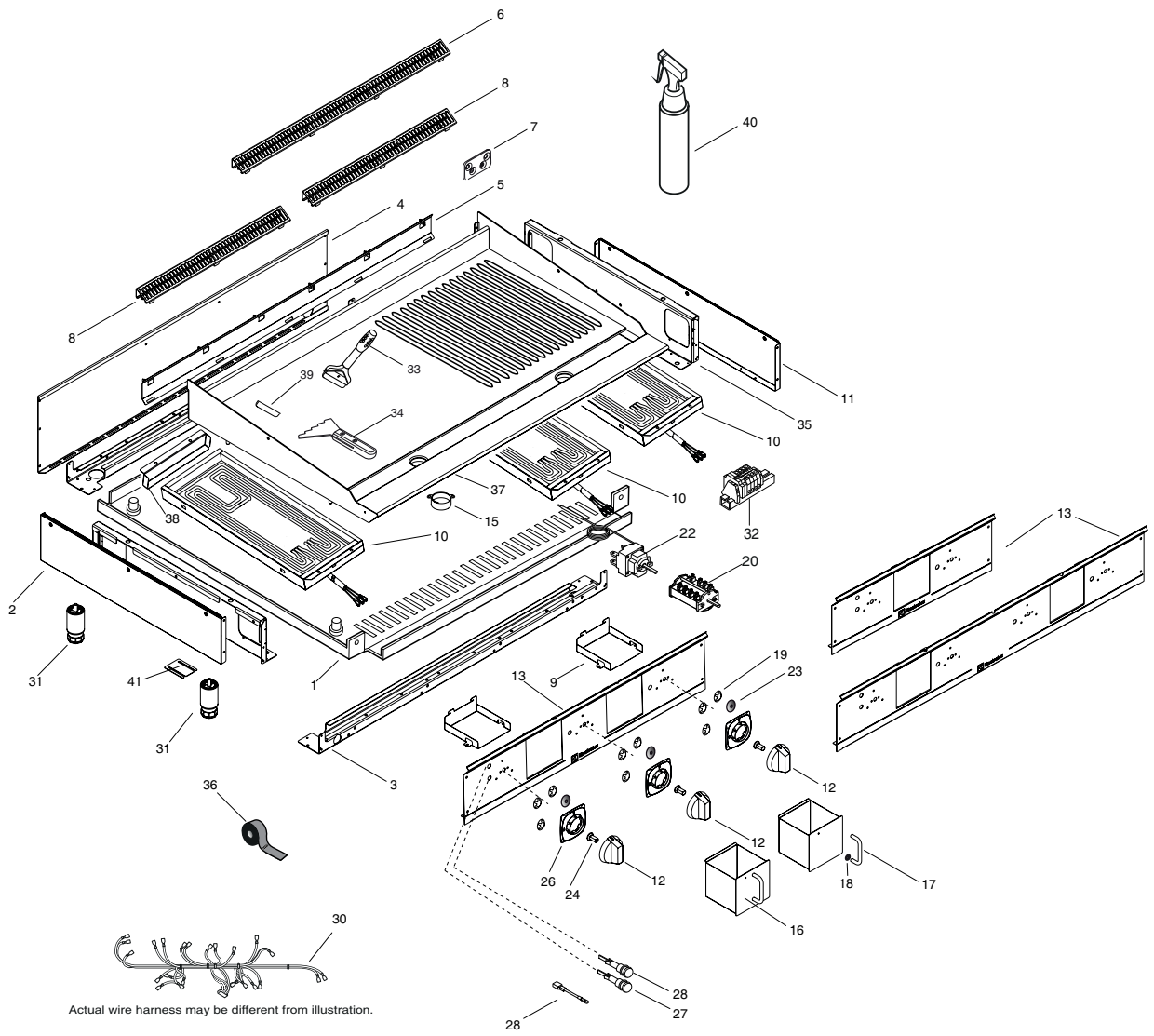

PNC	Ref	PNC	Ref
169167	A	169170	D
169168	B	169171	E
169169	C	169172	F

Pos	SPARE PART CODE	FACTORY CODE	DESCRIZIONE	DESCRIPTION	REF/NOTE
1	0C9619	5038A8U00	FONDO PIANO 24"	UNDER PANEL 24"	A,C
1	0C9620	5038A8V00	FONDO PIANO 36"	UNDER PANEL 36"	B,D
1	0CA054	5038A8W00	FONDO PIANO 48"	UNDER PANEL 48"	E,F
2	0C6716	530885100	FIANCO SINISTRO	LEFT SIDE PANEL	A
3	*	*	TRAVERSA	CROSS PANEL	
4	0CA030	5038ADH00	SCHIENALE 24"	BACK PANEL 24"	A,C
4	0CA031	5038ADJ00	SCHIENALE 36"	BACK PANEL 36"	B,D
4	0CA032	5038ADK00	SCHIENALE 48"	BACK PANEL 48"	E,F
5	*	*	TRAVERSA POSTERIORE	BACK CROSS PANEL	
6	0C6725	509805A01	GRIGLIA CAMINO 36"	CHIMNEY COVER36"	
7	0C6733	50689A700	PIASTRINA UNIONE	CONNECTION BRACKET	
8	0C6633	509805B01	GRIGLIA CAMINO 24"	CHIMNEY COVER 24"	A
9	0CA218	50489TJ00	GUIDA CASSETTO	GREASE TRAY GUIDE	
10	0C8453	617839F00	RESISTENZA	HEATING ELEMENT	
11	0C6715	530885000	FIANCO DESTRO	RIGHT SIDE PANEL	
12	0C8700	548877W00	MANOPOLA (CON ADATTATORE)	KNOB (WITH ADAPTOR)	
13	0CA215	50089A900	CRUSCOTTO 24"	CONTROL PANEL 24"	A,C
13	0CA216	50089AA00	CRUSCOTTO 36"	CONTROL PANEL 36"	B,D
13	0CA217	50089AB00	CRUSCOTTO 48"	CONTROL PANEL 48"	E,F
15	*	513803300	TUBO SCARICO	GREASE PIPE	
16	0C6724	856831401	CASSETTO COMPLETO	GREASE TRAY	
17	0C6653	50389CM01	MANIGLIA CASSETTO	TRAY HANDLE	
18	0C7119	214013145	VITE MANIGLIA	HANDLE SCREW	
19	0C6288	218912211	ANELLO FISSAGGIO	RING STOPPER	
20	0A2134	A05400901	COMMUTATORE	REGULATOR	
22	*004363	646809500	TERMOSTATO	THERMOSTAT	
23	0C6171	541813800	RONDELLA SILICONE	SILICONE WASHER	
24	0C7345	548877V00	ADATTATORE MANOPOLA	KNOB ADAPTER	A
26	0CA222	80589D000	ASSIEME GHIERA	KNOB RING ASSEMBLY	
27	005010	876800002	LAMPADA VERDE COMPLETA	GREEN LAMP, COMPLETE	
27*	0C2585	660806900	LAMPADINA	BULB	
27*	0C2587	655800100	LENTE VERDE	GREEN LENS	
28	005011	876800102	LAMPADA ARANCIONE COM- PLETA	ORANGE LAMP, COMPLETE	
28*	0C0249	660805600	LAMPADINA	BULB	
28*	0C2182	655800200	LENTE ARANCIO	ORANGE LENS	

* =Component on demand / componente a richiesta

** = Bold text = changes / Grassetto = cambiamenti

PNC	Ref	PNC	Ref
169167	A	169170	D
169168	B	169171	E
169169	C	169172	F

Pos	SPARE PART CODE	FACTORY CODE	DESCRIZIONE	DESCRIPTION	REF/NOTE
29	005370	638865100	RESISTENZA DI CADUTA	DIMMER	
30		634803F00	ASSIEME CAVETTI 24"	WIRE HARNESS 24"	A,C
30		634803G00	ASSIEME CAVETTI 36"	WIRE HARNESS 36"	B,D
30		634803301	ASSIEME CAVETTI 48"	WIRE HARNESS 36"	E,F
31	0C6634	835873400	PIEDINO	FOOT	
32	0F0035	639808700	MORSETTIERA ALIMENTAZIONE	MAIN TERMINAL BOARD	
33	055995	805848202	RASCHIETTO PIASTRA LISCIA	SCRAPER FOR SMOOTH PLATE	
34	056940	830851300	SPATOLA PIASTRA RIGATA	SCRAPER FOR RIBBED PLATE	
35	0C6717	533885800	STRUTTURA LATERALE	INNER SIDE PANEL	A
36	0C2496	543821900	GUARNIZIONE SPUGNA CRU-SCOTTO	CONTROL PANEL GASKET	
37	0C9585	83089HL00	PIASTRA FRY TOP 24"	SMOOTH PLATE 24"	A
37	0C9586	83089HM00	PIASTRA FRY TOP 36"	SMOOTH PLATE 36"	B
37	0CA055	83089HN00	PIASTRA FRY TOP 48"	SMOOTH PLATE 48"	E
37	0C9587	83089HQ00	PIASTRA 24" - ½ LISCIO E RIGATO	½ SMOOTH & RIBBED PLATE 24"	C
37	0C9588	83089HR00	PIASTRA 36" - ½ LISCIO E RIGATO	½ SMOOTH & RIBBED PLATE 36"	D
37	0CA033	83089HS00	PIASTRA 48" - ½ LISCIO E RIGATO	½ SMOOTH & RIBBED PLATE 48"	F
38	0C9624	50489NZ00	SUPPORTO RESISTENZA	HEATING ELEMENT SUPPORT	A
39	0C2519		LAMA PER RASCHIETTO	SCRAPER BLADE FOR SMOOTH PLATE	10pcs per code
39	056340		LAMA PER RASCHIETTO (angoli smussati)	SCRAPER BLADE S.P. (blade rounded edge)	2pcs per code
40	0S0990		SGRASSANTE GREASE CUTTER	GREASE CUTTER	1pcs = 6 x 0,75lt bottles
40	0S0841		SGRASSANTE GREASE CUTTER	GREASE CUTTER	1pcs = 4 x 5lt bottles
41	094290	502R44200	DISTANZIALE X RUOTE	WHEEL SPACER	

* =Component on demand / componente a richiesta

** = Bold text = changes / Grassetto = cambiamenti